

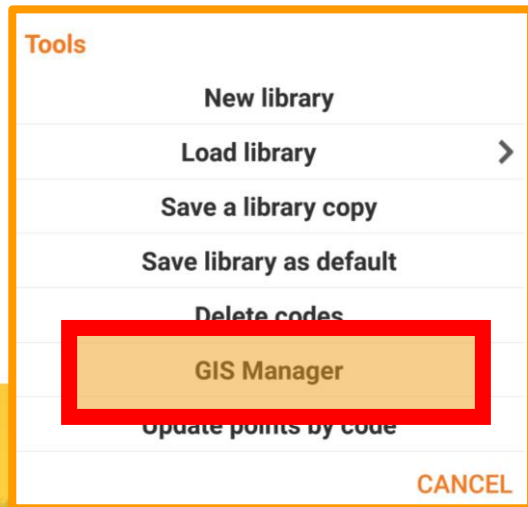

GE  **MAX**

Create GIS Features

- After completing job setup select Points/Measurements/Codes
- Select the Codes menu, select tools, and select GIS Manager

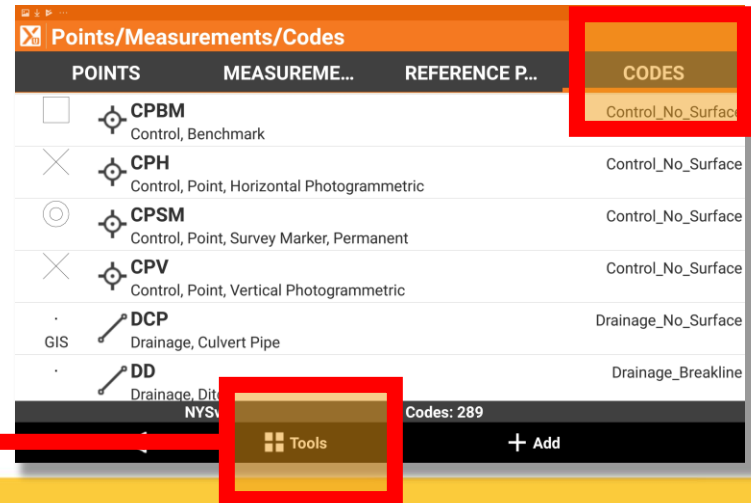
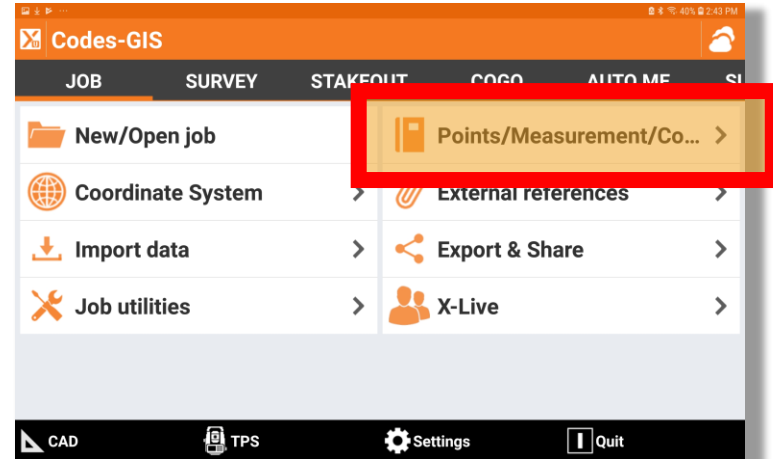

Create GIS Feature

- Select +Add to add a new GIS feature
- Input the feature name and select +Add to input attributes



Create GIS Feature

- Input the name of the attribute
- Select the drop down menu beside type and select the answer type of the attribute

Type

Text

Integer number

Real number

Yes/No

Title

CANCEL

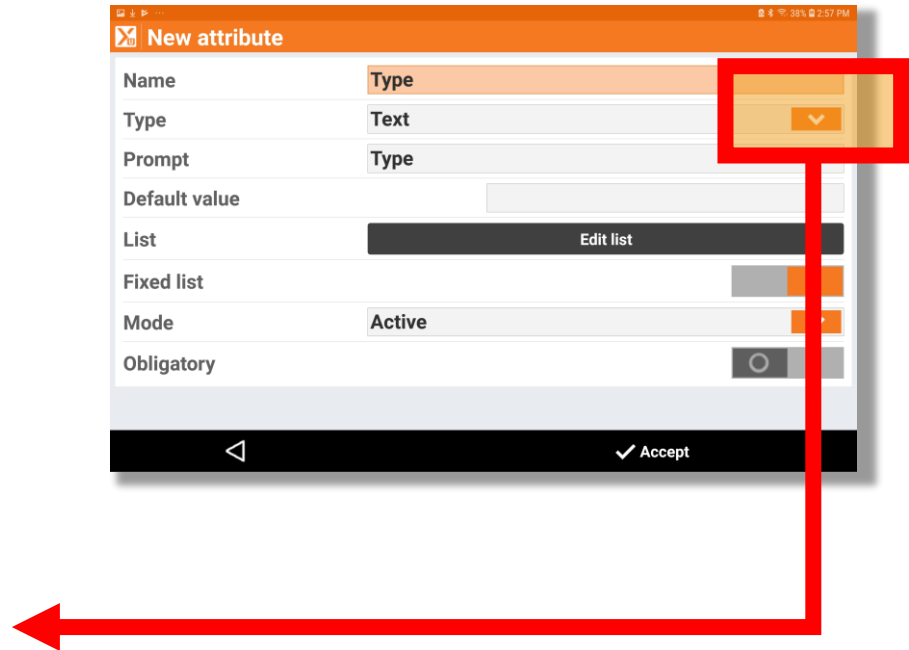

New attribute

Name	Type
Type	Text
Prompt	Type
Default value	
List	Edit list
Fixed list	
Mode	Active
Obligatory	

Accept



Create GIS Feature

- You can input a default value
- You can create a predefined list of answers for the attribute by selecting “Edit list”
- You can adjust the mode by selecting the drop down menu
- You can make the attribute mandatory to answer if feature is added to a specific code by turning on the “obligatory” option

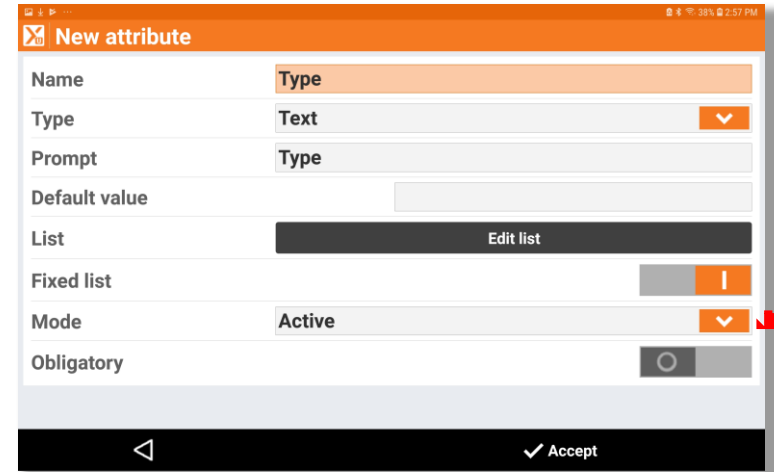
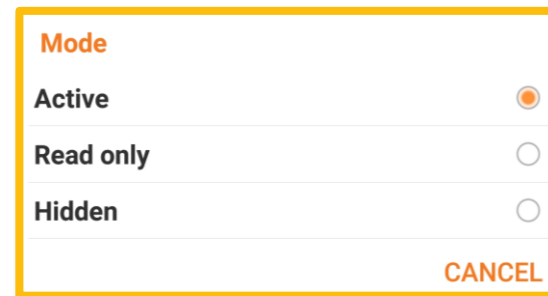
Create GIS Feature

- Once you have the attribute finished you select accept
- Then select accept in the New GIS Feature screen

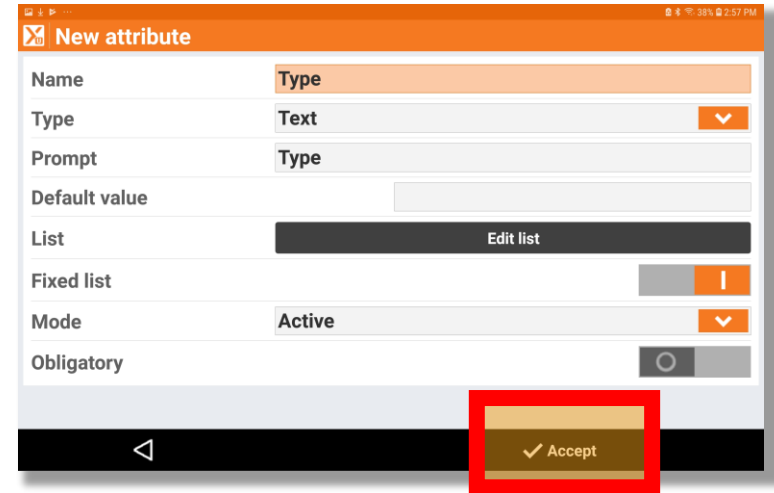

New attribute

Name

Type

Prompt

Default value

List

Fixed list

Mode

Obligatory

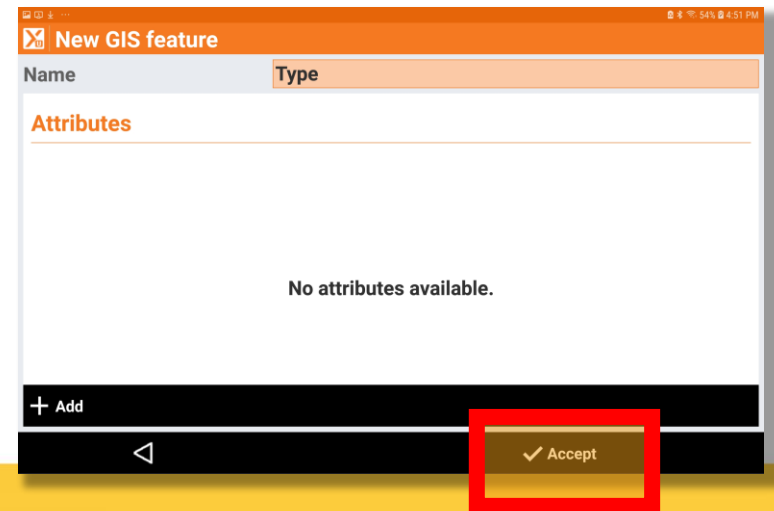

New GIS feature

Name

Type

Attributes

No attributes available.



Create GIS Feature

- You can now see your new GIS Features and they are now able to be attached to codes

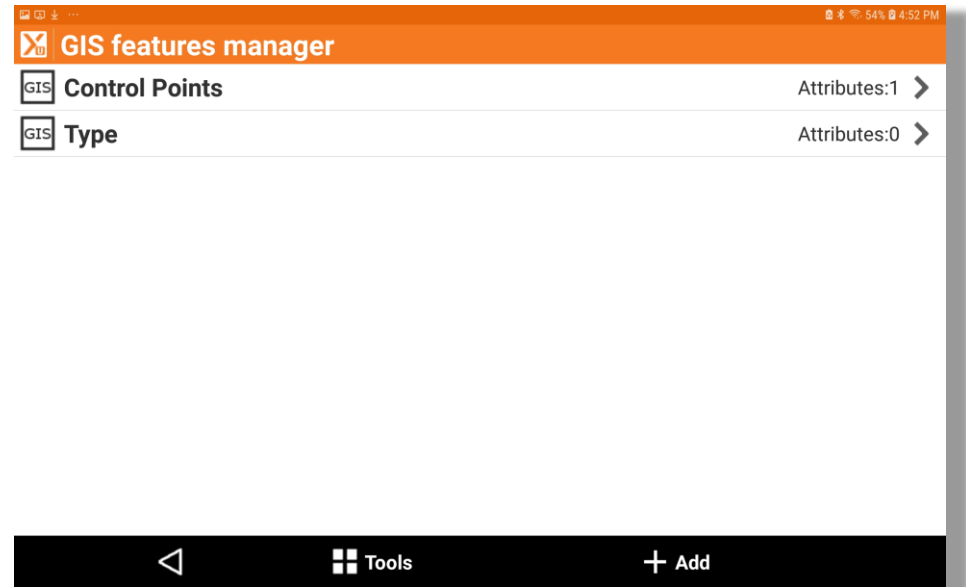

Codes & GIS

Comments and suggestions to

academy@geomax-positioning.com

