



GE  **MAX**

Import GIS Features

Import XDG

- Paste XDG file to Internal Storage>X-Pad>Data>Codes

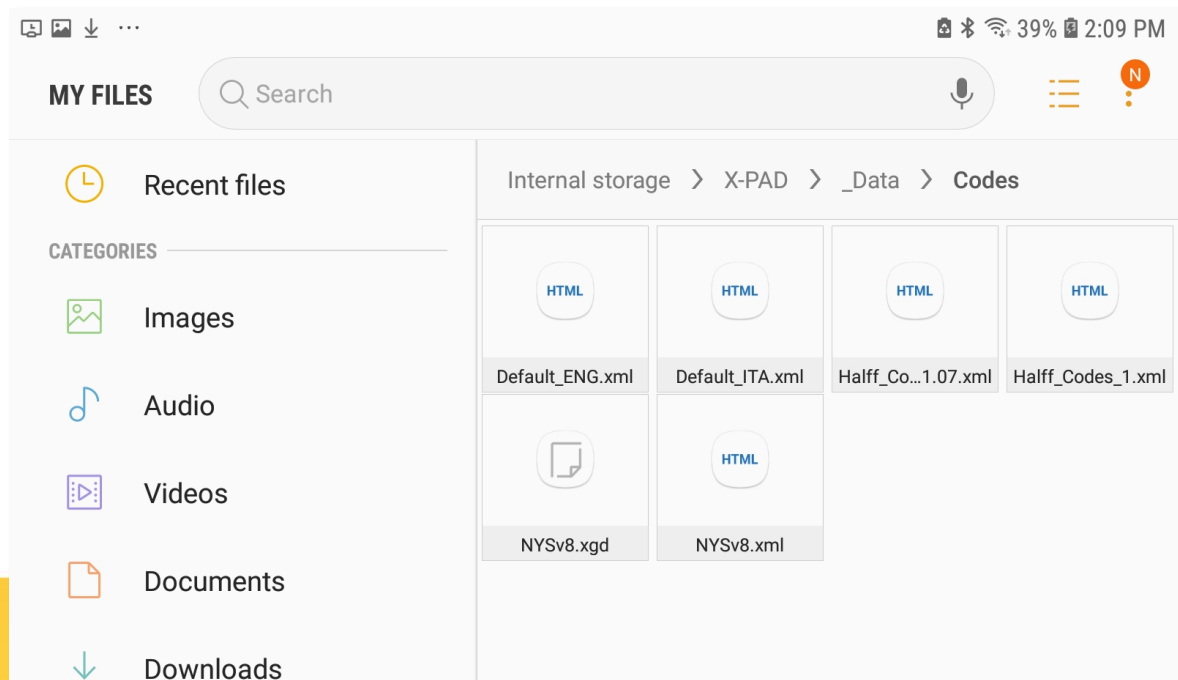

Import XDG

- When creating new job select side menu option on GIS Features
- Select your GIS Feature XDG file

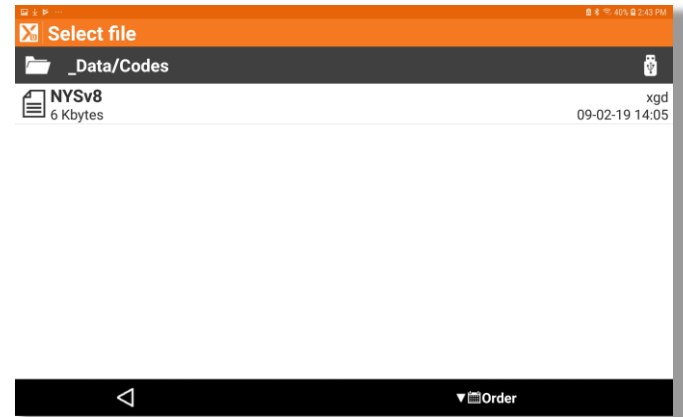
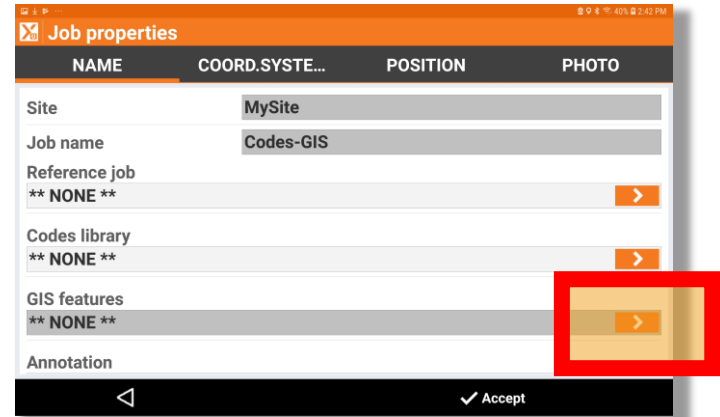

Import XDG

- After completing job setup select Points/Measurements/Codes
- Select the Codes menu, select tools, and select GIS Manager

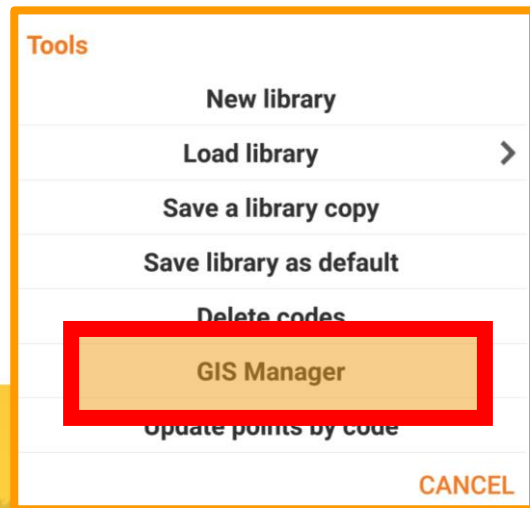
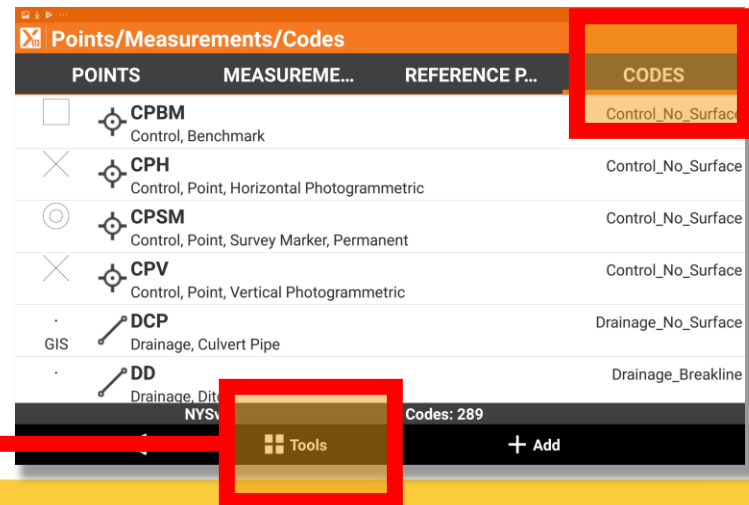
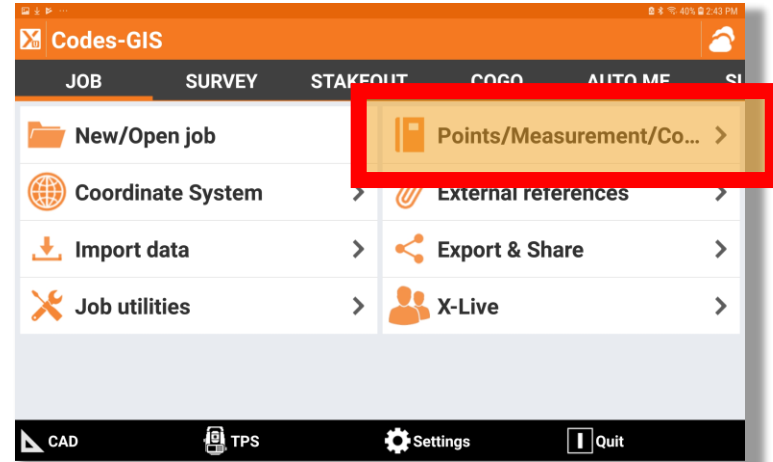

Import XDG

- You can now see all of your imported GIS Features

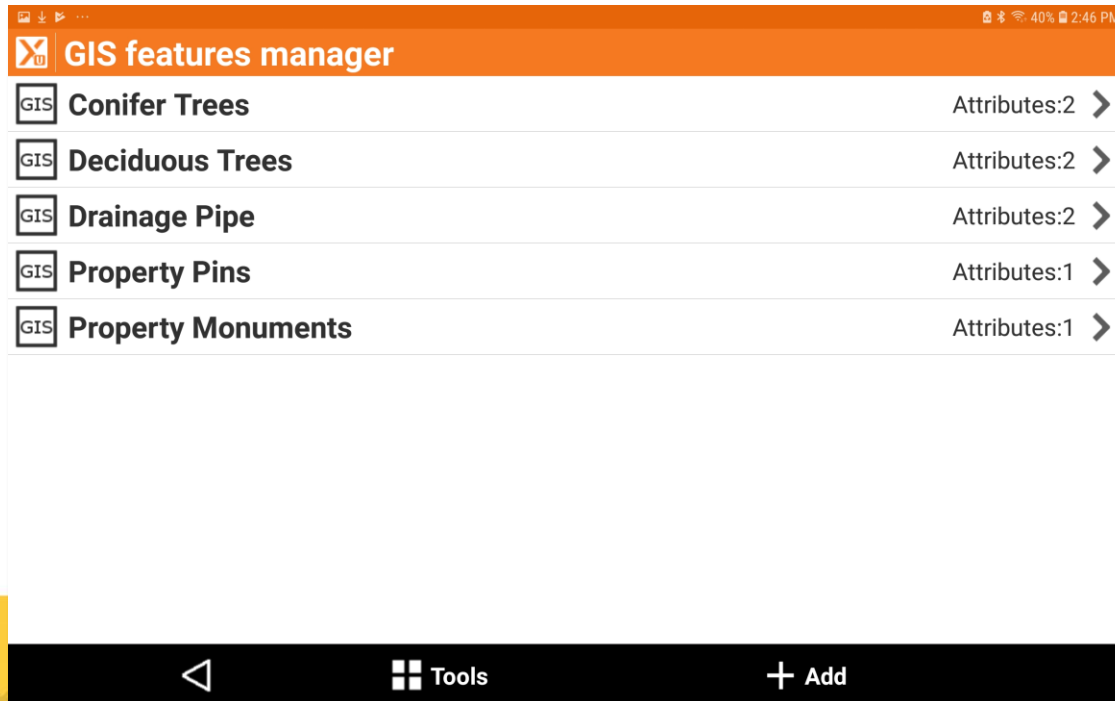

Import GIS Features

Comments and suggestions to

academy@geomax-positioning.com

